



\*1006122778\*

**GOLD FOSSICKING AREA # 21  
FIVE MILE CREEK**

Gazetted on 23 March 2000 over an area of 9.9 hectares.

**SUMMARY:**

GFA 21 is over the same area as previous mining licence (32 1280) held by the Queenstown Lakes District Council which expired on 18 April 1999.

**SCHEDULE**

**GOLD FOSSICKING APPLICATION No. 21**

**BEING** a strip of land 20 metres either side of and parallel to the centre line of Five Mile Creek;

**COMMENCING** at the confluence of the Five Mile Creek and the mean high water of Lake Wakatipu and proceeding upstream of the said creek for a distance of 2500 metres but excluding legal road.

**LEGAL DESCRIPTION:**

Part Reserve B  
Part Run 794

**OWNERSHIP:**

D.O.C. - Rec Reserve Gaz 1891 p1049  
Crown Pastoral Lease 6D/1163  
lessee - Quest Moonlight Ltd

both of above being Block I Mid Wakatipu Survey District, Otago Land District

**AREA:** 10.0 hectares approximately

**LOCAL AUTHORITY:** Queenstown Lakes District



Pt Run 794  
SO 18490

# PLAN OF GOLD FOSSICKING AREA

APPLICATION No. GFA 21

LOCAL AUTHORITY: Queenstown Lakes District Council

LAND DISTRICT: Otago

AREA: 10.0 ha approx.

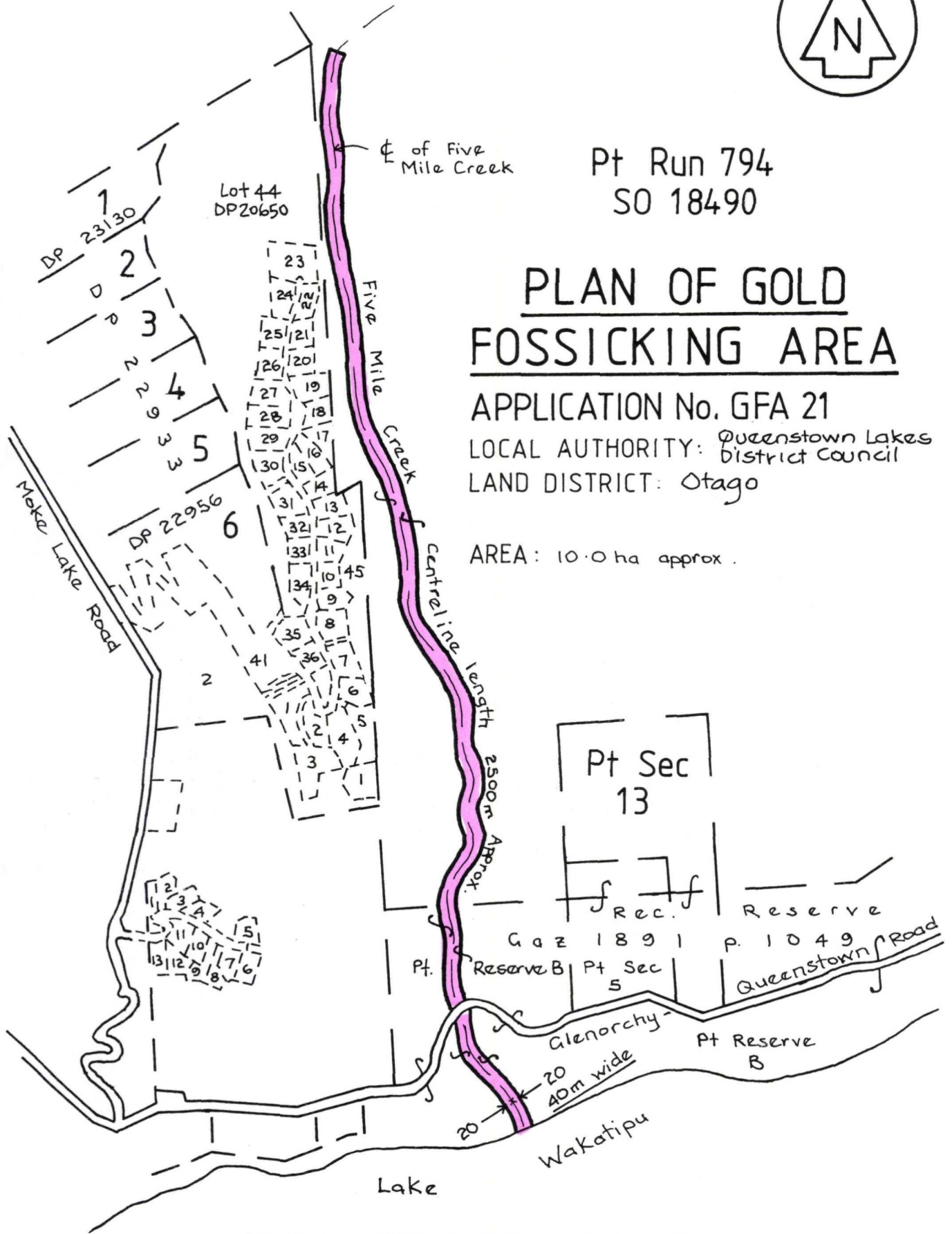

BLK 1, MID WAKATIPU S.D.



**D.G. HATFIELD  
& ASSOCIATES**

**SURVEYING & RESOURCE MANAGEMENT  
DUNEDIN MOSGIEL BALCLUTHA**

SCALE 1:12500

JOB No.

PLAN No.

DATE Dec '99

6281

6281/2

## Designation of Various Gold Fossicking Areas

Pursuant to section 98 of the Crown Minerals Act 1991, I hereby designate as gold fossicking areas the areas of land listed in the Schedule.

Information on gold fossicking in these areas, including detailed maps, may be inspected during normal business hours at the Ministry of Commerce Library, Ministry of Commerce Building, 33 Bowen Street, Wellington and the Queenstown Lakes District Council, Stanley Street, Queenstown.

### Schedule

GFA 20 Twelve Mile Creek, 11.5 hectares approximately, being a strip of land 20 metres either side of and parallel to the centre line of the Twelve Mile Creek, more particularly described as:

All that area of land commencing at the confluence of the Twelve Mile Creek and the mean high water mark of Lake Wakatipu and proceeding upstream of the Twelve Mile Creek for a distance of 2,900 metres approximately, to the point where the said creek ceases to be the boundary of Section 1, S.O. 22360, Block IV, and Section 39, S.O. 21822, Block V, Mid Wakatipu Survey District, but excluding legal road, being Part Sections 1, 39, 53, 54, 61, 62 and Part Bed of Twelve Mile Creek situated in Block IV, Mid Wakatipu Survey District and Part Bed of Twelve Mile Creek and Part Section 1, situated in Block V, Mid Wakatipu Survey District, Queenstown Lakes District, Otago Land District.

GFA 21 Five Mile Creek, 10.0 hectares approximately, being a strip of land 20 metres either side of and parallel to the centre line of the Five Mile Creek, more particularly described as:

All that area of land commencing at the confluence of the Five Mile Creek and the mean high water mark of Lake Wakatipu and proceeding upstream of the said creek for a distance of 2,500 metres but excluding legal road being Part Reserve "B" and Part Run 794, situated in Block I, Mid Wakatipu Survey District, Queenstown Lakes District, Otago Land District.

GFA 22 Arrow River, 10.0 hectares approximately, being a strip of land 20 metres either side of and parallel to the centre line of the Arrow River, more particularly described as:

All that area of land commencing at the upstream end of the strip defined for mining application purposes shown on S.O. 23003, and proceeding downstream 2,500 metres approximately, to the downstream end of the said strip defined on S.O. 23003 being Part Bed of Arrow River and Part Crown land reserved from sale, situated in Block XVIII, Shotover Survey District, Part Section 11, Block XXIV, town of Arrowtown Survey District and Part Section 20, Block XXXVI, town of Arrowtown Survey District, Queenstown Lakes District, Otago Land District.

GFA 23 Shotover River, 9.6 hectares approximately, being a strip of land 20 metres either side and parallel to the centre line of the Shotover River, more particularly described as:

All that area of land commencing at the intersection of the upstream end of Section 85, Block IV, Shotover Survey District and the

centreline of the Shotover River and proceeding downstream of the Shotover River 2,400 metres approximately, to the downstream end of Section 85, Block IV, Shotover Survey District, situated in Part Section 85, Block IV, Shotover Survey District, Queenstown Lakes District, Otago Land District.

Dated at Wellington this 15th day of March 2000.

PETER COLIN HODGSON, Minister of Energy.

JOHN CUMBERPATCH, Regional General Manager (Southern), pursuant to a delegation from the Minister of Conservation.

ln2042