



10061227676

**GOLD FOSSICKING AREA # 22
ARROW RIVER**

Gazetted on 23 March 2000 over an area of 10 hectares.

SUMMARY:

GFA 22 is over the same area as previous mining licence (32 1284) held by the Queenstown Lakes District Council which expired on 18 April 1999.

SCHEDULE

GOLD FOSSICKING APPLICATION No. 22

BEING a strip of land 20 metres either side of and parallel to the centre line of the Arrow River;

COMMENCING at the upstream end of the strip defined for mining application purposes shown on Survey Office Plan no. 23003, and proceeding downstream of the Arrow River 2500 metres approximately to the downstream end of the said strip defined on SO 23003.

LEGAL DESCRIPTION:

Part bed of Arrow River
Part Crown Land Reserved from Sale

OWNERSHIP:

Crown Land - no registration
Crown Land - Sec 58 Land Act 1948

both of above being Block XVIII Shotover Survey District, Otago Land District

Part Section 11 Block XXIV

D.O.C. - Part Arrowtown Rec Reserve
CT 9C/271

Part Section 20 Block XXXVI

D.O.C. - Part Arrowtown Rec Reserve
Gaz 1982 p 4111

both of above being Town of Arrowtown, Otago Land District.

AREA: 10.0 hectares

LOCAL AUTHORITY: Queenstown Lake District

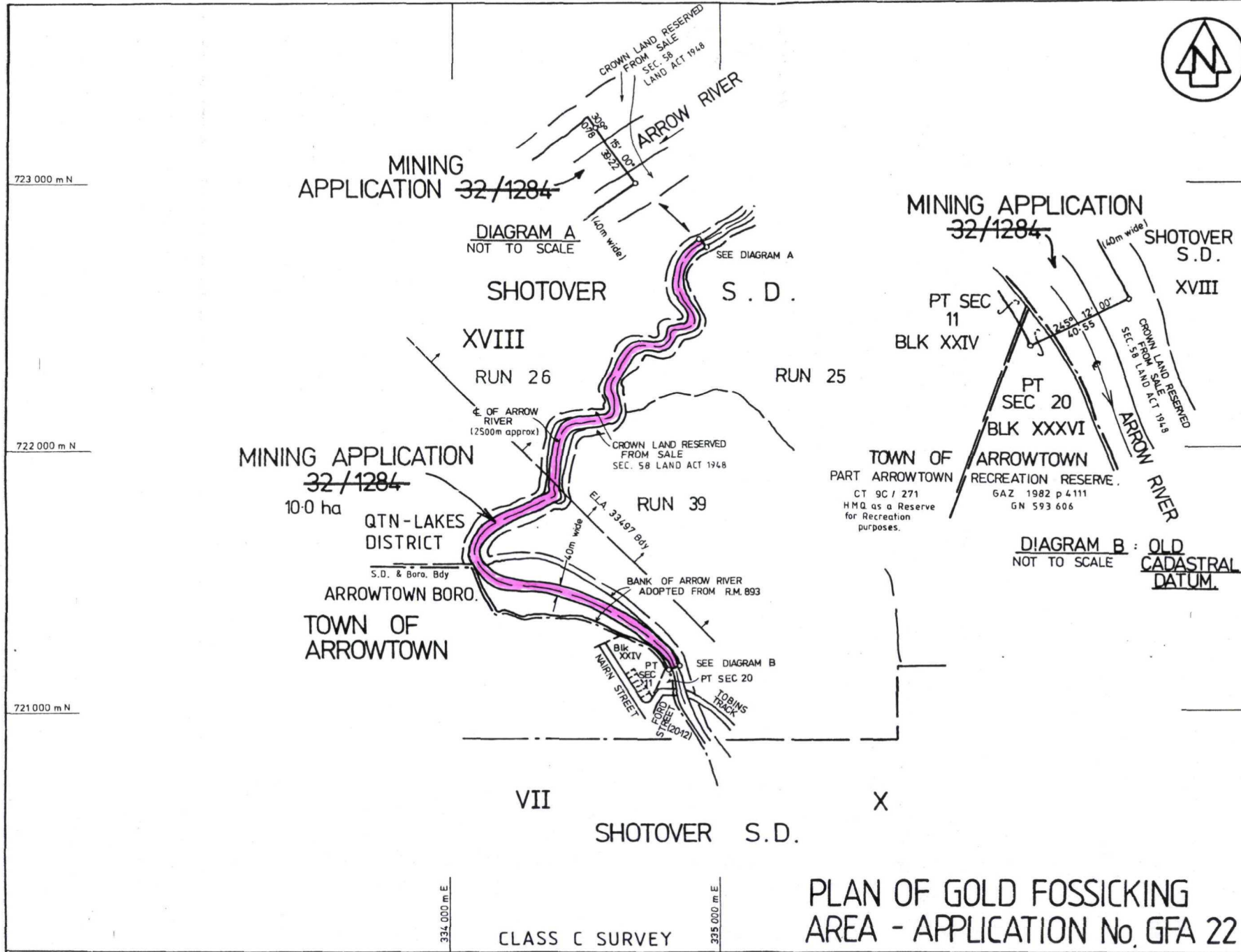

Approvals
 Certified Pursuant to Section 73(3) of The Mining Act 1971 as being satisfactory for the purpose of identifying the land in application 32/1284.

Chief Surveyor _____ Date _____

Appellations subject to Mining Application ~~32/1284~~ are: Pt Bed Arrow River, Crown Land Reserved From Sale, Pt Sec 11 Blk XXIV, Town of Arrowtown, Pt Sec 20 Blk XXXVI, Town of Arrowtown.

DIAGRAM B DATUM: OLD CADASTRAL
 COORDINATE ORIGIN: TRIG O SHOTOVER S.D.

All roads are legal.
 DATUM GEODETIC 1949
 CIRCUIT MOUNT NICHOLAS
 COORDINATES FROM FALSE ORIGIN
 700 000 m N 300 000 m E

Total Area 10.0 ha

Comprised in Crown Land-no title, Crown Land Res. from sale (Sec. 58 Land Act 1958), Pt CT 9C/271, GN 593 606

I, CHARLES HUGHES OF CROMWELL
 Registered Surveyor and holder of an annual practising certificate (or who may act as a registered surveyor pursuant to section 25 of the Survey Act 1986) hereby certify that this plan has been made from surveys executed by me or under my directions, that both plan and survey are correct and have been made in accordance with the Survey Regulations 1972 or any regulations made in substitution thereof.
 Dated at Cromwell this 17 day of March 1989
 Signature Charles Hughes

Field Book 2311 p.47-50 Traverse Book 243 p.97-98
 Reference Plans S.O.20941 S.O.21477 S.O.13707
 D.P.19338, R.M.893 S.O.16390 Interior Run Roll 1890
 Examined under T.C.1478/2 Correct

Approved as to Survey _____
 22.1.3.189 Chief Surveyor

Deposited this _____ day of _____ 19 _____
 District Land Registrar

File Received Instructions SO 23003

LAND DISTRICT OTAGO
 XVIII, SHOTOVER S.D.
 SURVEY BLK. & DIST. XXIV & XXXVI, Tn. Arrowtown.
 NZMS 261 SHT F41 RECORD MAP No 436/893

CLASS C SURVEY
 PLAN OF MINING APPLICATION 32/1284

TERRITORIAL AUTHORITY ARROWTOWN BOROUGH & QUEENSTOWN LAKES, DISTRICT
 Surveyed by HUGHES & ASSOCIATES
 Scale 1:5000 Date FEB 1989

Designation of Various Gold Fossicking Areas

Pursuant to section 98 of the Crown Minerals Act 1991, I hereby designate as gold fossicking areas the areas of land listed in the Schedule.

Information on gold fossicking in these areas, including detailed maps, may be inspected during normal business hours at the Ministry of Commerce Library, Ministry of Commerce Building, 33 Bowen Street, Wellington and the Queenstown Lakes District Council, Stanley Street, Queenstown.

Schedule

GFA 20 Twelve Mile Creek, 11.5 hectares approximately, being a strip of land 20 metres either side of and parallel to the centre line of the Twelve Mile Creek, more particularly described as:

All that area of land commencing at the confluence of the Twelve Mile Creek and the mean high water mark of Lake Wakatipu and proceeding upstream of the Twelve Mile Creek for a distance of 2,900 metres approximately, to the point where the said creek ceases to be the boundary of Section 1, S.O. 22360, Block IV, and Section 39, S.O. 21822, Block V, Mid Wakatipu Survey District, but excluding legal road, being Part Sections 1, 39, 53, 54, 61, 62 and Part Bed of Twelve Mile Creek situated in Block IV, Mid Wakatipu Survey District and Part Bed of Twelve Mile Creek and Part Section 1, situated in Block V, Mid Wakatipu Survey District, Queenstown Lakes District, Otago Land District.

GFA 21 Five Mile Creek, 10.0 hectares approximately, being a strip of land 20 metres either side of and parallel to the centre line of the Five Mile Creek, more particularly described as:

All that area of land commencing at the confluence of the Five Mile Creek and the mean high water mark of Lake Wakatipu and proceeding upstream of the said creek for a distance of 2,500 metres but excluding legal road being Part Reserve "B" and Part Run 794, situated in Block I, Mid Wakatipu Survey District, Queenstown Lakes District, Otago Land District.

GFA 22 Arrow River, 10.0 hectares approximately, being a strip of land 20 metres either side of and parallel to the centre line of the Arrow River, more particularly described as:

All that area of land commencing at the upstream end of the strip defined for mining application purposes shown on S.O. 23003, and proceeding downstream 2,500 metres approximately, to the downstream end of the said strip defined on S.O. 23003 being Part Bed of Arrow River and Part Crown land reserved from sale, situated in Block XVIII, Shotover Survey District, Part Section 11, Block XXIV, town of Arrowtown Survey District and Part Section 20, Block XXXVI, town of Arrowtown Survey District, Queenstown Lakes District, Otago Land District.

GFA 23 Shotover River, 9.6 hectares approximately, being a strip of land 20 metres either side and parallel to the centre line of the Shotover River, more particularly described as:

All that area of land commencing at the intersection of the upstream end of Section 85, Block IV, Shotover Survey District and the

centreline of the Shotover River and proceeding downstream of the Shotover River 2,400 metres approximately, to the downstream end of Section 85, Block IV, Shotover Survey District, situated in Part Section 85, Block IV, Shotover Survey District, Queenstown Lakes District, Otago Land District.

Dated at Wellington this 15th day of March 2000.

PETER COLIN HODGSON, Minister of Energy.

JOHN CUMBERPATCH, Regional General Manager (Southern), pursuant to a delegation from the Minister of Conservation.

ln2042